

STEP 09

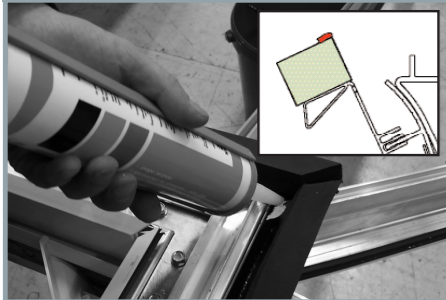

Run a continuous bead of sealant (see sketch) along the top rear edge of the close-cell-foam (to bed the cill on) and also seal any butt joints in the foam.

STEP 10



Place cill section onto the bed of silicone and press firmly into position. Screw the cill into the head of the ringbeam 200mm in from each corner and at 450mm centres. Always silicone the head of each fixing.

STEP 11



Sealant the area at the junction of the top capping and the rain baffle, not forgetting the mitre joint of the baffle above the georgian hip bar capping.

STEP 12



Proceed with upper frames and roof. Fit all internal claddings.

Technical Support

T: 0870 414 1008

F: 0870 414 1018

E: techsupport@ultraframe.co.uk



Ultraframe (UK) Ltd
Salthill Road,
Clitheroe,
Lancashire. BB7 1PE

Fabricator First Team tel : 08704 141006
Installer First Team tel : 08704 141002

www.ultraframe.com

ultraframe Classic



TO BE READ IN CONJUNCTION
WITH THE CLASSIC
INSTALLATION GUIDE

It is Ultraframe's policy to continually seek to improve its products, processes and services, and we reserve the right to change specifications without prior notice. Ultraframe is a trading name of Ultraframe (UK) Limited.

LBIC001 UJT 160606 30



world class
conservatory
systems

Lantern Ringbeam Installation Guide

Version: 1.0

To be read in conjunction with the standard Classic Victorian Installation Guide
 (Photographs are for illustrative purposes only and have been artificially created to illustrate the correct installation method)

Thank you for choosing the Lantern Ringbeam as part of your Classic Victorian Roof.

Before starting the installation please take a moment to read this guide which should be used in conjunction with the standard Classic Victorian installation guide, issued with your roof.

Before you start please ensure that you have the following tools -

- Screwdriver bit (Pozi), size PZ3
- Screwdriver bit (Philips), size PH1
- Masonry drill bit - 10mm
- Steel drill bit - 11mm
- Socket spanner - 10mm
- Silicone (Low modulus neutral cure) or MS polymer sealant if using Conservaglass

The Health and Safety of the installer, householder and the general public must be observed at all times.

Personal Protective Equipment and Safe Working Platforms must also be used.

COMPONENT IDENTIFICATION

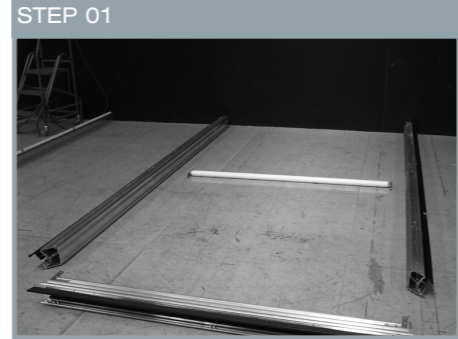
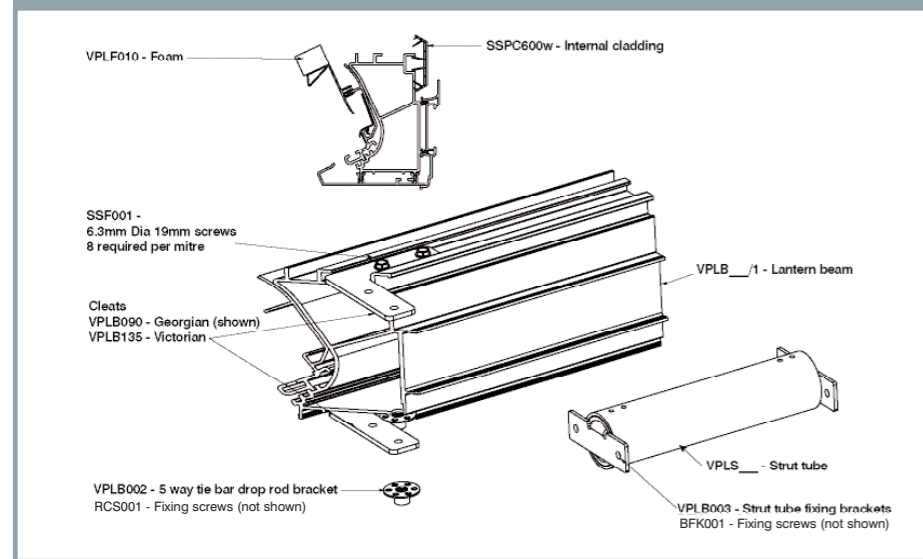

STEP 01
Lay the lantern ringbeam and cross strut, if supplied, on the conservatory floor.



STEP 02
Each end of the lantern ringbeam (front section) will have two factory fitted 90 degree jointing cleats.



STEP 03
Also attached to each end of the eaves bottom section (when required) is a 5 way, vertical drop rod, connecting spigot.

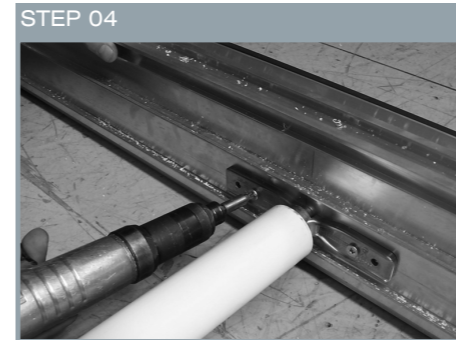

STEP 04
Prior to assembling the lantern ringbeam, secure the horizontal cross strut (if supplied) to each side section of the ring beam, into the pre-drilled holes.

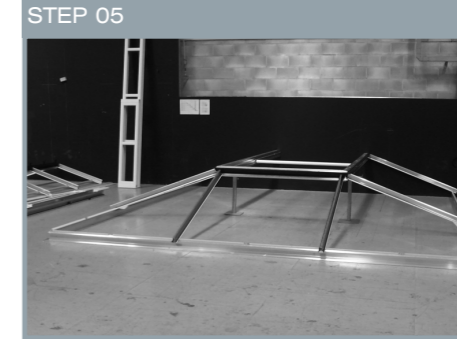

STEP 05
Assemble the ringbeam, securing the cleats (including lower drop rod cleat, when required) using the fixings provided. Lift into position (Note: height to base of ringbeam from top of window frames is stated on the component location plan). Attach the rear starter bars and then transoms nearest to each front corner, this will help support the roof whilst the remaining bars are attached.



STEP 06
Assemble and fit the pre-cut tie bar assemblies. The vertical bars attach to the drop rod connecting spigot (as shown, when required).



STEP 07
In some situations the vertical drop rod will be attached to a tie bar bracket. Ensure all tie bars are tensioned prior to glazing.



STEP 08
Apply lengths of 20mm thick close-cell-foam (supplied) to the top surface of the upper rain baffle leg, flush with rear edge (see sketch).